

↗ DOMETIC

MOBILE COOLING

CFX3



CFX3 25, CFX3 35, CFX3 45, CFX3 55, CFX3 55IM,
CFX3 75DZ, CFX3 95DZ, CFX3 100

EN	Compressor Cooler Short operating manual.	SV	Kylbox med kompressor Kortfattad användarhandbok
DE	Kompressor-Kühlbox Kurzbedienungsanleitung	NO	Kjøleboks med kompressor Hurtigveiledning
FR	Glacière à compression Guide rapide	FI	Kompressori-kylmälaatikko Pikaopas
ES	Nevera por compresor Guía rápida	RU	Компрессорный холодильник Краткая инструкция по эксплуатации.
PT	Geleira com compressor Manual do utilizador resumido	PL	Przenośna lodówka kompresorowa Krótka instrukcja obsługi
IT	Frigorifero a compressore Manuale dell'utente breve	SK	Chladiaci box s kompresorom Stručný návod
NL	Compressorkoelbox Korte gebruikershandleiding	CS	Kompressorový chladič box Stručný návod
DA	Kompressor-køleboks Lynvejledning	HU	Kompresszor hűtőláda Rövid használati útmutató

© 2020 Dometic Group. The visual appearance of the contents of this manual is protected by copyright and design law. The underlying technical design and the products contained herein may be protected by design, patent or be patent pending. The trademarks mentioned in this manual belong to Dometic Sweden AB. All rights are reserved.

⚠ DANGER

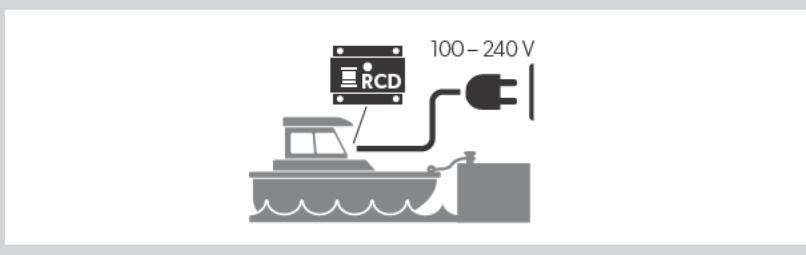
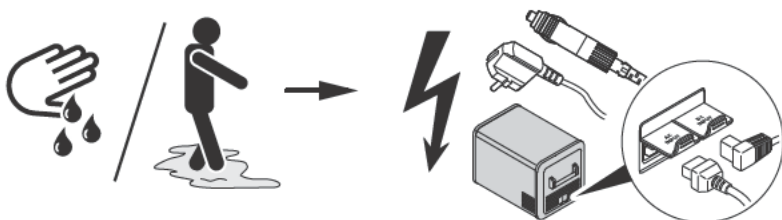

⚠ WARNING

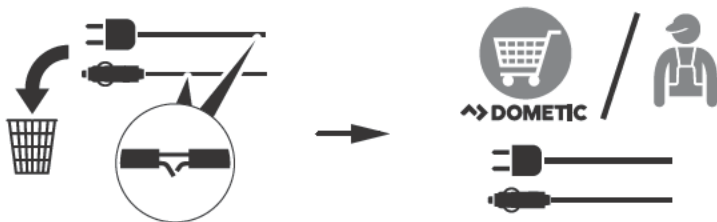

⚠ CAUTION

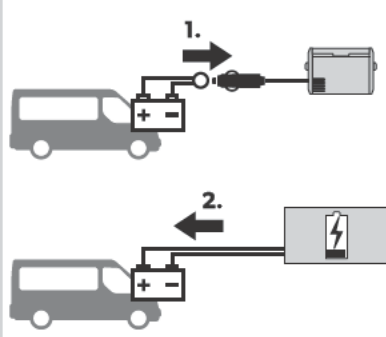
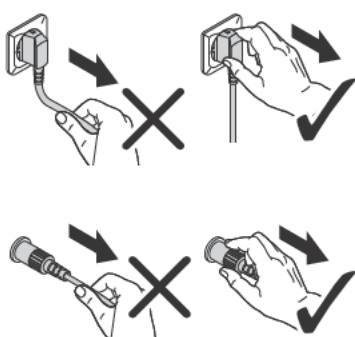

CAUTION

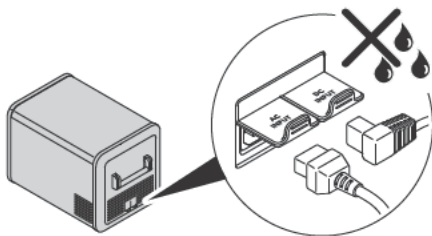

NOTICE

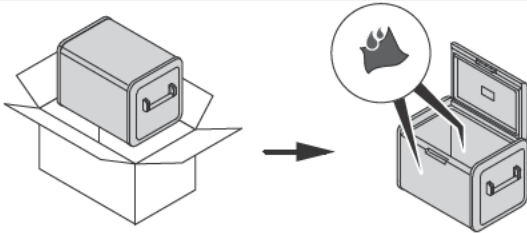
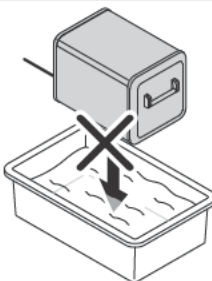
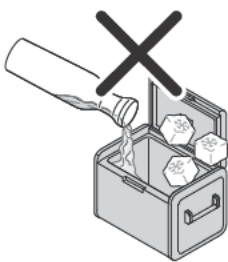
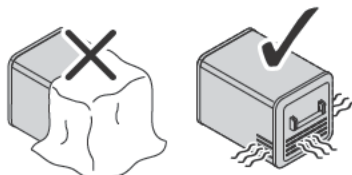
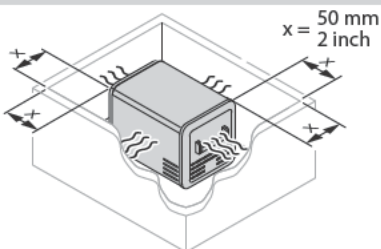
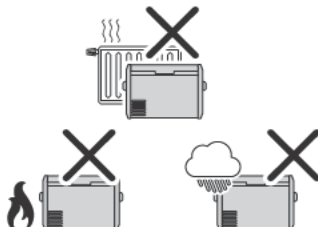
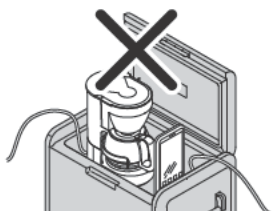

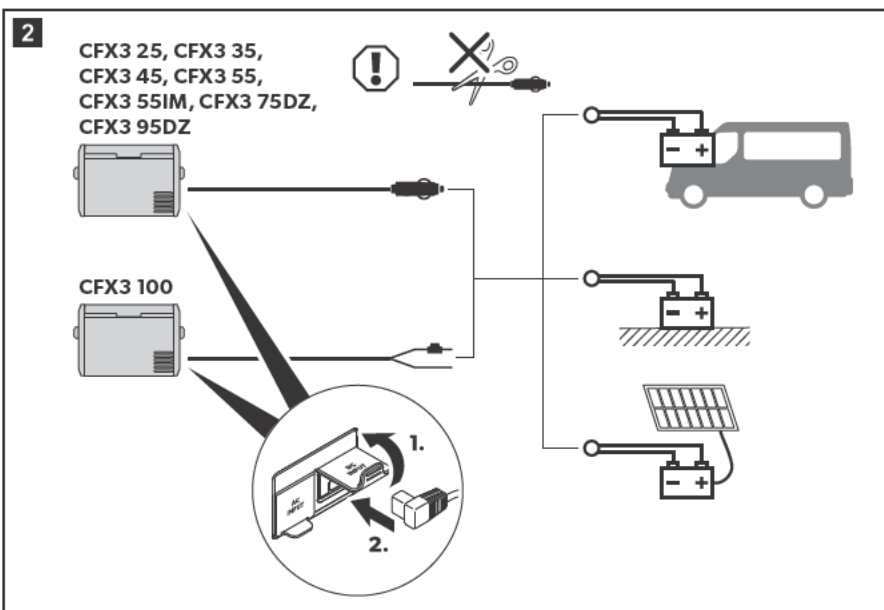
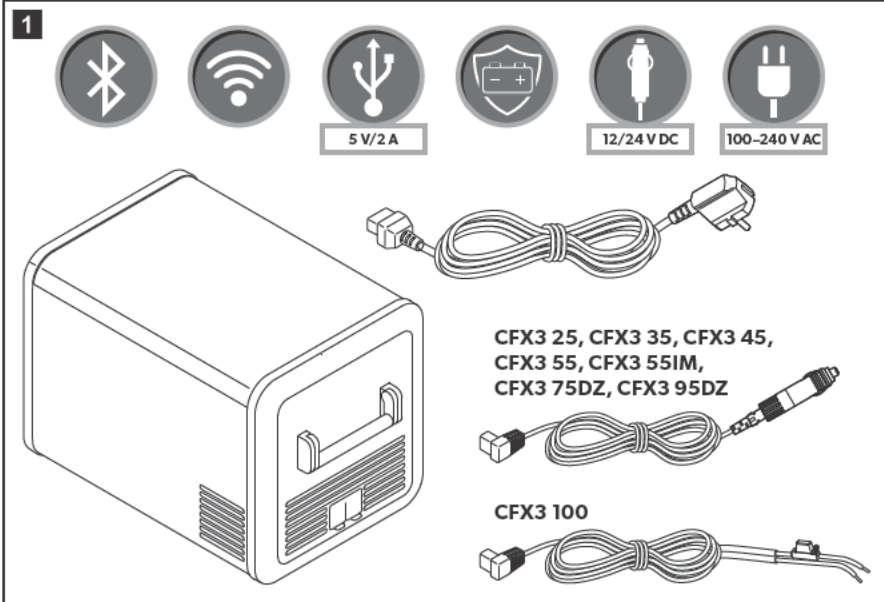

3 CFX3 100

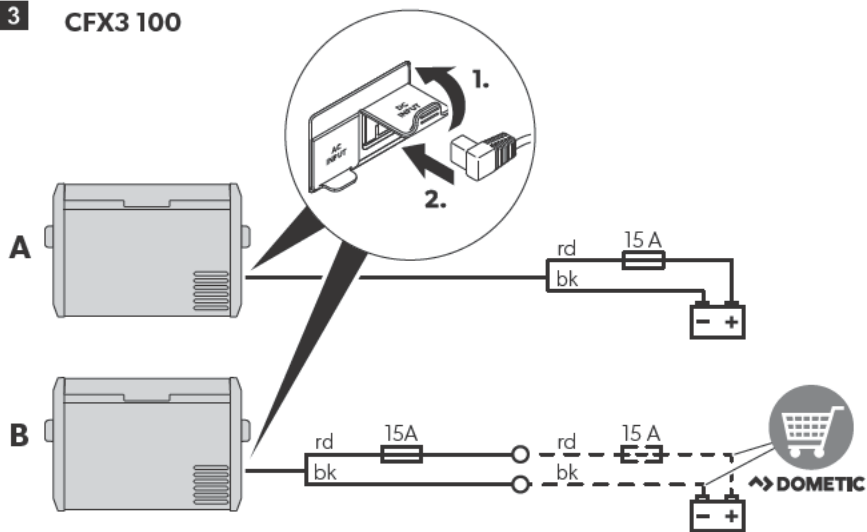

EN	DE	FR	ES	PT	IT	NL	DA	SV	
bk	Black	Schwarz	Noir	Negro	Preto	Nero	Zwart	Sort	Svart
rd	Red	Rot	Rouge	Rojo	Vermelho	Rosso	Rood	Rød	Röd

NO	FI	RU	PL	SK	CS	HU	
bk	Svart	Musta	Черный	Czarny	Čierna	Černá	Fekete
rd	Rød	Punainen	Красный	Czerwony	Červená	Červená	Piros



AWG Ø/mm²

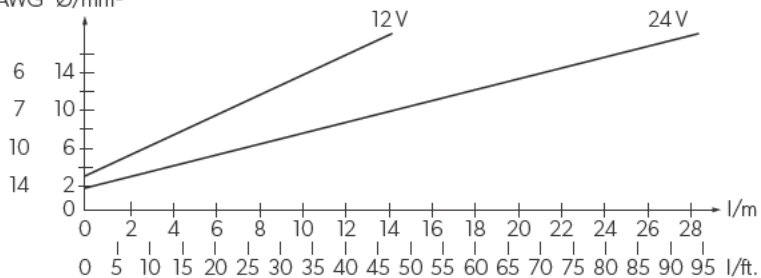

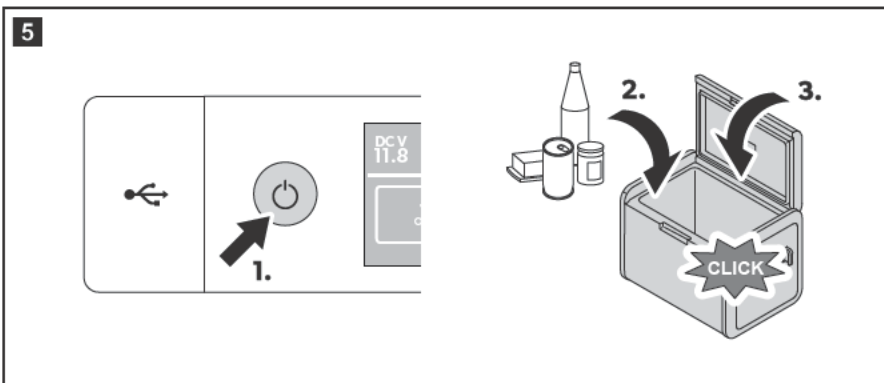
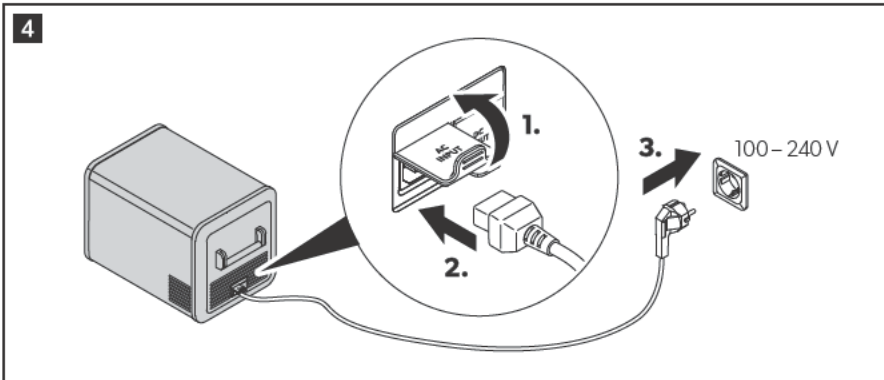

6

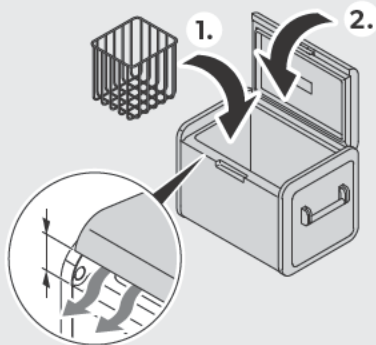
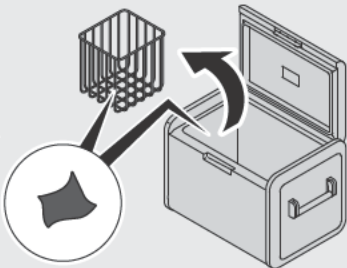
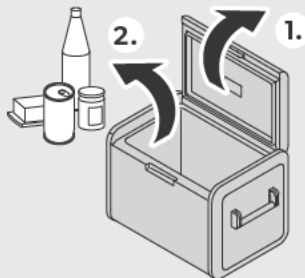
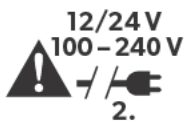
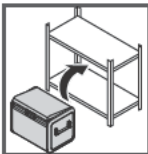

7

**CFX3 25/CFX3 35/
CFX3 45/CFX3 55/
CFX3 100**



CFX3 55IM

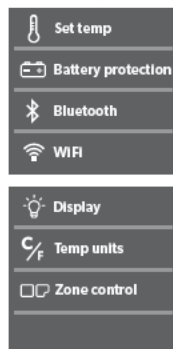
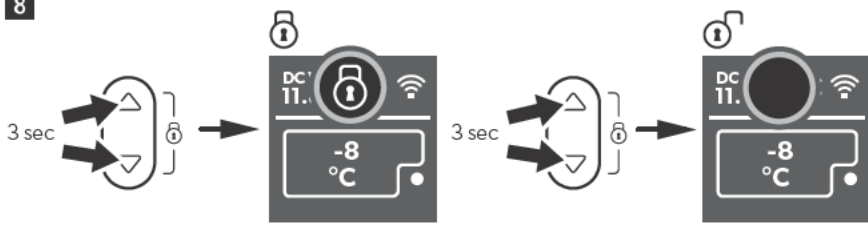
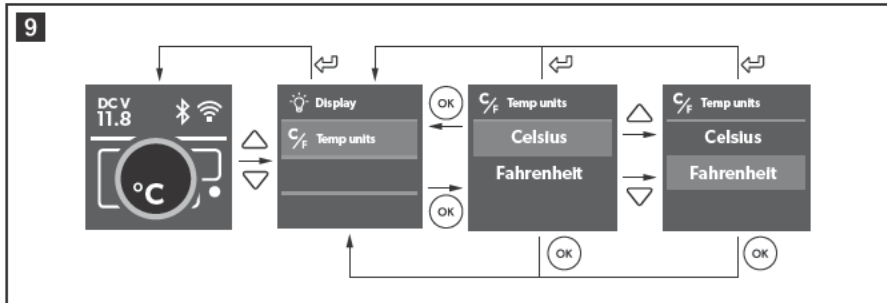

**CFX3 75DZ/
CFX3 95DZ**

**8****9**

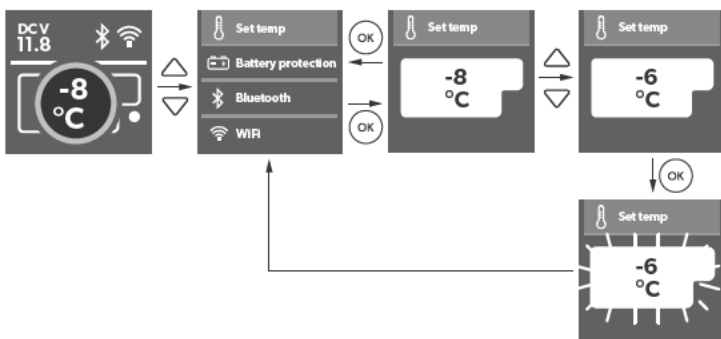
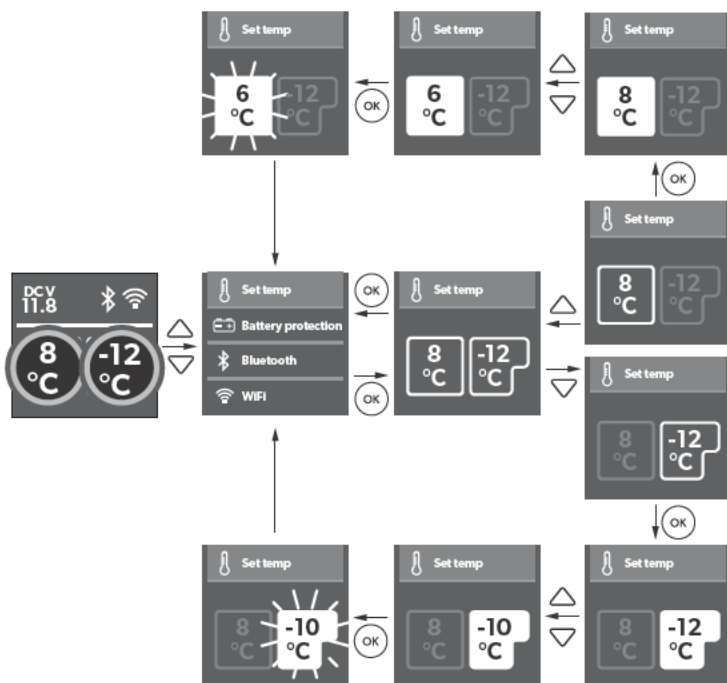
10**CFX3 25/CFX3 35/CFX3 45/CFX3 55/CFX3 55IM/CFX3 100****CFX3 75DZ/CFX3 95DZ**

11

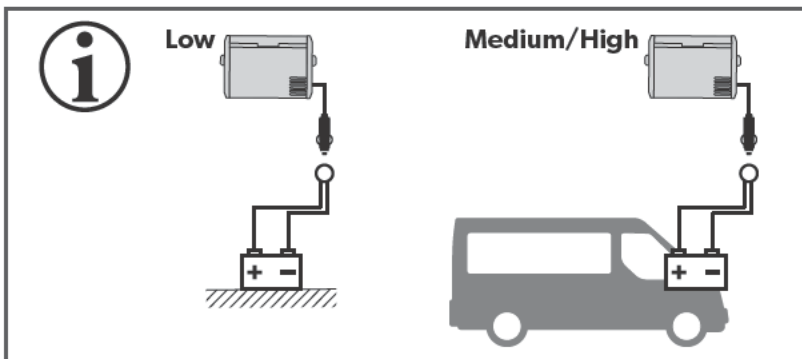
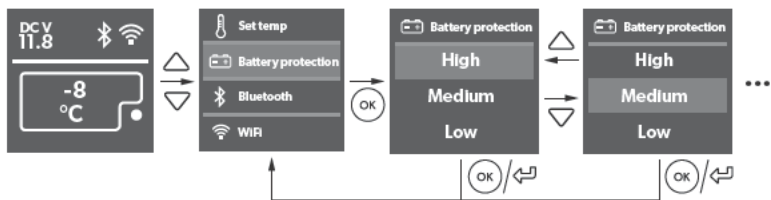

		Low	Medium	High
12V 	OFF	10.1V	11.2V	11.8V
	ON	11.4V	12.2V	12.6V
24V 	OFF	21.5V	24.1V	24.6V
	ON	23.0V	25.3V	26.2V

12

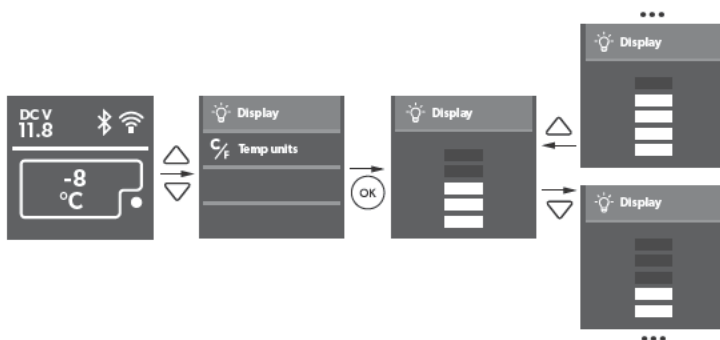

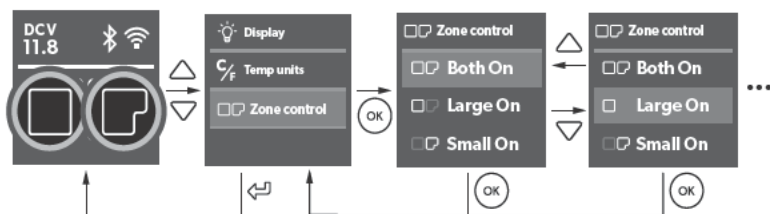
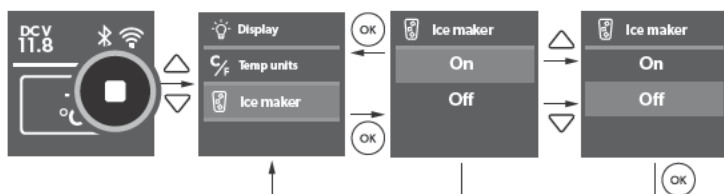
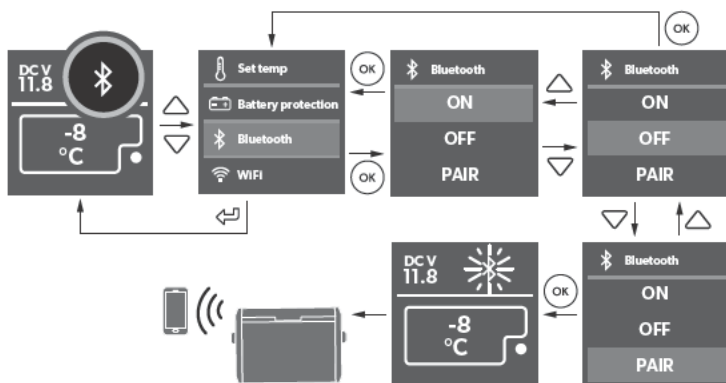
13**CFX3 75DZ/CFX3 95DZ****14****CFX3 55 IM****15**

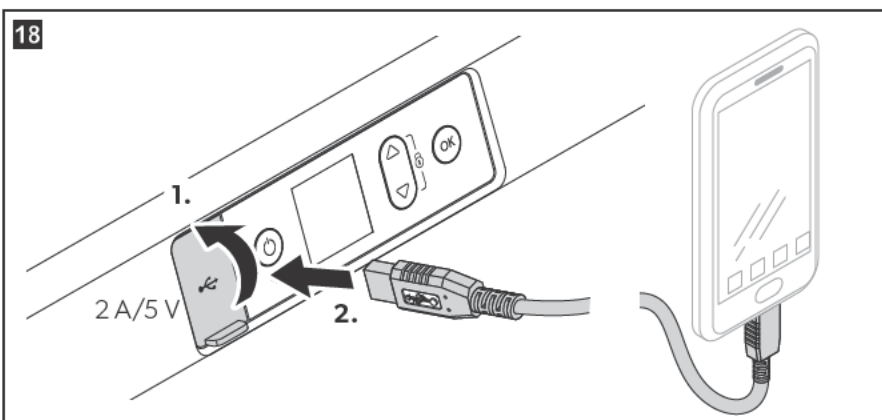
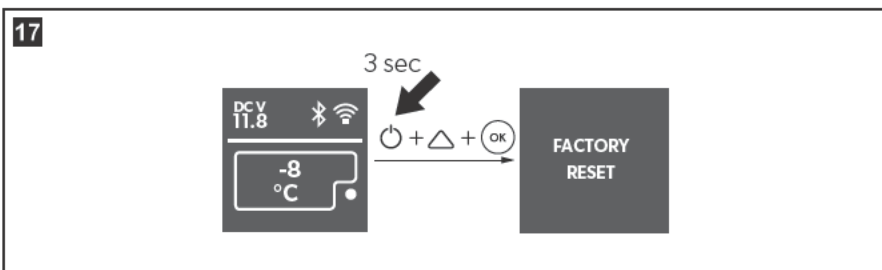
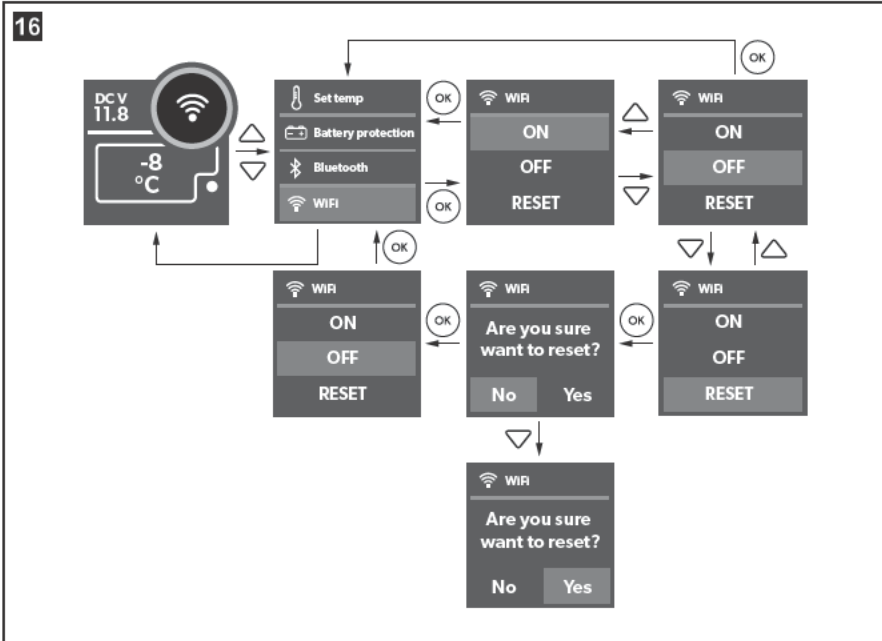

19

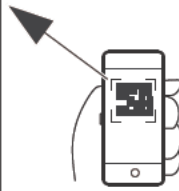
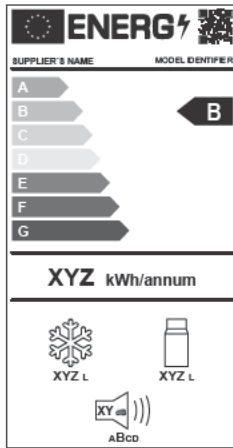

eprel.ec.europa.eu

Please read these instructions carefully and follow all instructions, guidelines, and warnings included in this product manual in order to ensure that you install, use, and maintain the product properly at all times. These instructions **MUST** stay with this product.

By using the product, you hereby confirm that you have read all instructions, guidelines, and warnings carefully and that you understand and agree to abide by the terms and conditions as set forth herein. You agree to use this product only for the intended purpose and application and in accordance with the instructions, guidelines, and warnings as set forth in this product manual as well as in accordance with all applicable laws and regulations. A failure to read and follow the instructions and warnings set forth herein may result in an injury to yourself and others, damage to your product or damage to other property in the vicinity. This product manual, including the instructions, guidelines, and warnings, and related documentation, may be subject to changes and updates. For up-to-date product information, please visit www.dometic.com.



Find the full operating manual online on documents.dometic.com/?object_id=71785



WARNING!

Also observe the safety instructions on page 3 to page 4.

Safety instructions



WARNING! Failure to obey these warnings could result in death or serious injury.

Electrocution hazard

- Do not operate the cooling device if it is visibly damaged.
- If this cooling device's power cable is damaged, it must be replaced by the manufacturer, a service agent or a similarly qualified person in order to prevent safety hazards.
- This cooling device may only be repaired by qualified personnel. Improper repairs can lead to considerable hazards.

Health hazard

- This device can be used by children aged from 8 years and above and persons with reduced physical, sensory or mental capabilities or lack of experience and knowledge if they have been given supervision or instruction concerning use of the device in a safe way and understand the hazards involved.
- Children shall not play with the device.
- Cleaning and user maintenance shall not be made by children without supervision.

- Children aged from 3 to 8 years are allowed to load and unload cooling devices.

Explosion hazard

- Do not store any explosive substances such as spray cans with a flammable propellant in the cooling device.

Fire hazard

- When positioning the device, ensure the supply cord is not trapped or damaged.
- Do not locate multiple portable socket-outlets or portable power supplies at the rear of the device.
- Keep the ventilation openings on the device housing or in installations free of obstructions.
- Do not use any mechanical objects or other means to speed up the defrosting process, unless they have been recommended by the manufacturer for this purpose.
- Do not damage the refrigerant circuit.



CAUTION! Failure to obey these cautions could result in minor or moderate injury.

Health hazard

- Please check if the cooling capacity of the device is suitable for storing the food or medicine you wish to cool.
- Food may only be stored in its original packaging or in suitable containers.
- Opening the lid for long periods can cause significant increase of the temperature in the compartments of the device.
- Clean regularly surfaces that can come in contact with food and accessible drainage systems.
- If the device is left empty for long periods:
 - Switch off the device.
 - Defrost the device.
 - Clean and dry the device.
 - Leave the lid open to prevent mould developing within the device.



NOTICE! Damage hazard

- Only carry the cooling device upright.
- Check that the voltage specification on the type plate corresponds to that of the energy supply.
- The insulation of the cooling device contains flammable cyclopentane and requires special disposal procedures. Deliver the cooling device at the end of its life-cycle to an appropriate recycling center.

- Do not use electrical devices inside the cooling device unless they are recommended by the manufacturer for the purpose.
- **Hazard from excessively low temperature**
Ensure that only those objects are placed in the cooling device that are intended to be cooled at the selected temperature.
- The cooling device shall not be exposed to rain.

Intended use

The cooling device is intended to be used in household and similar applications such as

- staff kitchen areas in shops, offices and other working environments
- farm houses
- clients in hotels, motels and other residential type environments
- bed and breakfast type environments
- catering and similar non-retail applications

This cooling device is only suitable for the intended purpose and application in accordance with these instructions.

This manual provides information that is necessary for proper installation and/or operation of the cooling device. Poor installation and/or improper operating or maintenance will result in unsatisfactory performance and a possible failure.

The manufacturer accepts no liability for any injury or damage to the product resulting from:

- Incorrect assembly or connection, including excess voltage
- Incorrect maintenance or use of spare parts other than original spare parts provided by the manufacturer
- Alterations to the product without express permission from the manufacturer
- Use for purposes other than those described in this manual

Dometic reserves the right to change product appearance and product specifications.

Operation

Saving energy

- Choose a well ventilated location which is protected from direct sunlight.
- Allow warm food to cool down first before placing it in the cooling device to keep cool.
- Do not open the cooling device more often than necessary.
- Do not leave the cooling device open for longer than necessary.
- If the cooler has a basket: For optimal energy consumption, position the basket according to its position on delivery.
- On a regularly basis, make sure the lid seal still fits properly.

Operating

To avoid food waste, note the following:

- Keep temperature fluctuation as low as possible. Only open the cooling box as often and for as long as necessary. Store the foodstuff in such a way that the air can still circulate well.
- Adjust the temperature to the quantity and type of the foodstuff.
- Foodstuff can easily absorb or release odor or taste. Always store foodstuff covered or in closed containers/bottles.

Scope of delivery: fig. **1**

Proceed as shown:

- Connecting to a battery: fig. **2**
- Connecting via extended DC hard-wiring: fig. **3**
- Connecting to an AC power supply: fig. **4**
- Switching on the cooler: fig. **5**
- Switching off and storing the cooler: fig. **6**
- Display overview: fig. **7**
- Locking/unlocking the display: fig. **8**
- Selecting the temperature units: fig. **9**
- Setting the temperature: fig. **10**

- Using the battery monitor: fig. **11**
- Setting the display's brightness: fig. **12**
- Switching on or off the compartments: fig. **13**
- Switching on or off the icemaker: fig. **14**
- Setting the Bluetooth signal: fig. **15**
- Setting the WiFi signal: fig. **16**
- Resetting to factory settings: fig. **17**
- Using USB port for power supply: fig. **18**

Warranty

The statutory warranty period applies. If the product is defective, please contact the manufacturer's branch in your country (see dometic.com/dealer) or your retailer.

For repair and warranty processing, please include the following documents when you send in the device:

- A copy of the receipt with purchasing date
- A reason for the claim or description of the fault

Disposal

► Place the packaging material in the appropriate recycling waste bins wherever possible.



If you wish to finally dispose of the product, ask your local recycling centre or specialist dealer for details about how to do this in accordance with the applicable disposal regulations.

WiFi/Bluetooth

CFX3	
Frequency range:	WiFi: 2412 MHz – 2472MHz/ 2422 MHz – 2462MHz Bluetooth/BLE: 2402 MHz – 2480 MHz
Frequency band (WiFi):	2.4 GHz
RF output power:	WiFi: 16.62 dBm (802.11b), 16.23 dBm (802.11g), 16.45 dBm (802.11n20), 16.02 dBm (802.11n40) Bluetooth: 8.31 dBm Bluetooth LE: 6.67 dBm

Fulfills the European Radio Equipment Directive (RED) 2014/53/EU

Hereby, Dometic declares that the radio equipment type CFX3 is in compliance with Directive 2014/53/EU. The full text of the EU declaration of conformity is available at the following internet address: dometic.com.

Mobile living made easy.



dometic.com

**YOUR LOCAL
DEALER**

dometic.com/dealer

**YOUR LOCAL
SUPPORT**

dometic.com/contact

**YOUR LOCAL
SALES OFFICE**

dometic.com/sales-offices

A complete list of Dometic companies, which comprise the Dometic Group, can be found in the public filings of:
DOMETIC GROUP AB Hemvärnsgatan 15 SE-17154 Solna Sweden